

Automatic Stretch Wrapper

Our ARPAC Brand EWA-C Model is an Inline Conveyorized Rotary Tower style pallet wrapper combined with either a drag chain or roller conveyor. Like all of our pallet wrappers, the EWA-C is constructed of heavy-duty, welded steel structures designed for long life and machine stability. Complete with easy to use Allen-Bradley controls, the EWA-C is an ideal solution for integrating stretch wrapping into your packaging process.

A key benefit of this design is that no air is required, which makes this ideal for cold storage areas where air lines would freeze. It also offers a range of options for a variety of applications and load types, including either a drag chain or roller conveyor, cold and freezer packages, and tower and arm extensions for larger load types. Free standing control panels and other NEMA rated enclosures are also available.



APPLICATIONS

- Automotive
- Beverage
- Building Supplies
- Consumer Goods
- Contract Packaging
- Food
- Health & Beauty
- Material Handling
- Printing & Publishing

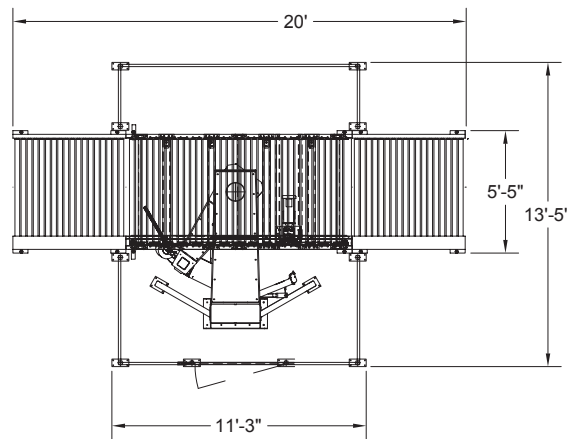

Final layout may vary.

FEATURES

- Heavy-duty, welded steel construction (no plastic panels) designed for long life
- Magnetic proximity switches in place of mechanical limit switches
- Long-range photo eye for automatic load height sensing
- Positive home position alignment
- Integrated film clamp
- Automatic indexing
- End pallet stop included
- Chain driven roller conveyor can support up to 4,000 lb.
- Three strand drag chain conveyor can support up to 3,000 lb.
- Adjustable top and bottom illuminated LED wrap counters
- Allen-Bradley® power, control, and safety components
- Allen-Bradley® MicroLogix™ PLC
- Built-in self-diagnostics
- Variable wrap arm speed using 3/4 HP, 90Vdc motor with ANSI 60 chain drive system
- Variable carriage speed up to 21 feet per minute
- EZ-Load® film pre-stretch dispenser for 20" film rolls
- Dual anti-static film rollers with manufacturer's lifetime warranty
- Electric clamp, cut, and wipe-down system
- Top film overwrap control feature (TOC)
- Electronic film tension adjustment control on control panel
- Belt lift for quiet operation
- Dual V-belt drive rotating arm
- Dancer bar variable corner compensation
- Flashing safety beacon
- Heavy-duty slewing bearing and NEMA 3 commutator
- NEMA 12 electrical cabinet
- UL/CSA approved components

OPTIONS

- Chain driven roller conveyor capable of supporting up to 4,000 lb.
- Three strand drag chain conveyor capable of supporting up to 3,000 lb.
- Tower and arm extensions for wrapping loads exceeding standard machine capability
- 30" film delivery system
- Cold and freezer packages available
- Free standing control panel
- Other NEMA rated control enclosures available
- Optional input voltages

SPECIFICATIONS

- Speed: 25-55 loads per hour
- Arm rotation speed up to 15 RPM
- Variable carriage speed up to 21 feet per minute
- Electrical power requirements: 230 V, 3 Ph, 60 Hz, 20 A, 2.4 kW
- Compressed air requirements: none
- Min load dimensions: 53" W x 53" L x 24" H
- Max load dimensions: 60" W x 60" L x 80" H standard, up to 110" H optional
- Film roll diameter: 20" standard
- Film pre-stretch capability from 150% to 300% stretch factor (200" standard)
- Machine dimensions: 240" L x 167" W (wrapper only) x 123" H (standard tower)